

## Licensing Sub-Committee

---

Meeting Venue

**By Zoom**

---

Meeting Date

**Tuesday, 4 April 2023**

---

Meeting Time

**10.00 am**

---

For further information please contact

**Carol Johnson**

01597 826206

carol.johnson@powys.gov.uk



County Hall  
Llandrindod Wells  
Powys  
LD1 5LG

24 March 2023

---

Mae croeso i chi siarad yn Gymraeg neu yn Saesneg yn y cyfarfod.

Rhowch wybod pa iaith rydych am ei defnyddio erbyn hanner dydd, ddau ddiwrnod gwaith cyn y cyfarfod.

You are welcome to speak Welsh or English in the meeting.

Please inform us of which language you wish to use by noon, two working days before the meeting.

---

### AGENDA

**The Sub-Committee Members are required to attend a private Briefing meeting at 9.30 a.m.**

<b>1.</b>	<b>APPLICATION FOR PREMISES LICENCE</b>
-----------	---

**1.1. Sub-Committee procedures**

To receive introductions by the Chair and an explanation of the Sub-Committee's procedures by the Principal Solicitor.

**1.2. Application for a licence**

To consider an application for a licence from Caffi Y Gaer, Brecon.

(Pages 3 - 24)

This page is intentionally left blank

# 1.b

## CYNGOR SIR POWYS COUNTY COUNCIL

### Licensing Sub-Committee Zoom Meeting at 10:00 on Tuesday the 04/04/2023

**REPORT BY:** Martin Phillips Licensing Officer

**SUBJECT:** Application for a Premises Licence for Caffi Y Gaer, Glamorgan Street, Brecon, Powys, LD3 7DW

---

**REPORT FOR:     DECISION**

---

## 1.     **APPLICATION**

- 1.1     On the -08/02/2023, an application for a Premises Licence was received from NPTC Group of Colleges for Caffi Y Gaer, Glamorgan Street, Brecon, Powys, LD3 7 DW
- 1.2     A location map of the premises is set out at **Annex A**, and a copy of the application and a plan of the premises are reproduced at **Annex B and Annex B1**.
- 1.3     The Proposed Premises is of mixed-use including College facilities, Seminar Facilities, and a Public Library.
- 1.4     The applicant & The Licensing Authority satisfied procedural obligations by consulting the Responsible Authorities and advertising the application.
- 1.5     The Applicant has applied for a Premises Licence authorising The Sale of Alcohol for both ON & OFF sales and Films 09:00 to 23:00 Monday to Sunday.

## 2.     **REPRESENTATIONS**

### 2.1     Responsible Authorities

There were No Objections from any of the Responsible Authorities.

However, Brecon Beacons National Park Authority Planning have requested that we advise the applicant that the application hours requested would be outside the current planning permission, The applicant has advised us that a new planning application has been submitted and they would be happy to amend the licensing hours to fall in line with the new planning permission if granted.

### 2.2     Other Persons

#### Objections

5 Representations have been received and the details of these representations are detailed and attached at Annex C.

### **3. OPTIONS**

- 3.1 In determining the application for the Premises Licence, the Sub-Committee must take such steps as are considered appropriate to promote the licensing objectives;
- i) The Prevention of Crime and Disorder
  - ii) Public Safety
  - iii) The Prevention of Public Nuisance
  - iv) The Protection of Children from Harm
- (3.2 If appropriate make reference to LA03 guidance or our Licensing policy if it relates to any of the points raised by objectors)
- 3.3 The options are to;
- a) grant the application as submitted by the applicant without modification, with the exception of the inclusion of mandatory conditions made under Section 19, Licensing Act 2003 (Supply of Alcohol); or
  - b) grant a licence with modified conditions; or
  - c) reject the whole or part of the application.

### **4. DETERMINATION**

- 4.1 The Licensing Sub-Committee is requested to determine the application.

# ANNEX A



LOCATION OF PREMISES

This page is intentionally left blank

# ANNEX B

## Cyngor Sir Powys County Council



FORM 9

### Application for a premises licence to be granted under the Licensing Act 2003

#### PLEASE READ THE FOLLOWING INSTRUCTIONS FIRST

Before completing this form please read the guidance notes at the end of the form.

If you are completing this form by hand please write legibly in block capitals. In all cases ensure that your answers are inside the boxes and written or typed in black ink. Use additional sheets if necessary.

Once completed please send your application to: -

#### CYNGOR SIR POWYS COUNTY COUNCIL The Licensing Officer

Council Offices Neuadd Brycheiniog Cambrian Way Brecon Powys LD3 7HR	Council Offices Y Gwalia Ithon Road Llandrindod Wells Powys LD1 6AA	Council Offices Ty Maldwyn Brook Street Welshpool Powys SY21 7PH
Contact: 0845 602 7037 and ask to speak to an Officer		

You may wish to keep a copy of the completed form for your records

I/We ... Y Gaer, NPTC Group of Colleges...  
(Insert name of applicant / applicants)

apply for a premises licence under section 17 of the Licensing Act 2003 for the premises described in Part 1 below (the premises) and I / we are making this application to you as the relevant licensing authority in accordance with section 12 of the Licensing Act 2003

<b>Part 1 – Premises Details</b>			
Postal address of premises if any or if none Ordnance Survey map reference or description.			
Y Gaer Glamorgan Street			
Post town	Brecon	Post code	LD37DW
Telephone number of premises (if any)			
£ Non-domestic rateable value of premises		UNKNOWN	

<b>Part 2 - Applicant Details</b>		
<b>Please state whether you are applying for a premises licence as</b>	<b>Please Tick or insert "YES" in the relevant box</b>	<b>Next Step</b>
a). An individual or individuals.		Please complete Section (A)
b). A person other than an individual.		Please complete Section (B)
i. as a limited company		Please complete Section (B)
ii. as a partnership		Please complete Section (B)
iii. as an unincorporated association or		Please complete Section (B)
iv. other (for example a statutory corporation)		Please complete Section (B)
c) A recognised club		Please complete Section (B)
d) A charity		Please complete Section (B)
e) The proprietor of an educational establishment	YES	Please complete Section (B)
f) A Health Service Body		Please complete Section (B)
g) A person who is registered under Chapter 2 of Part 1 of the Health and Social Care Act 2008 (within the meaning of that Part) in an independent hospital in England		Please complete Section (B)
h) The chief officer of police of a police force in England and Wales		Please complete Section (B)

<b>*If you are applying as a person described in (a) or (b) please confirm:</b>	
(Please state whether you are applying for a premises licence as)	Please tick <input checked="" type="checkbox"/>
I am carrying on or proposing to carry on a business which involves the use of the premises for licensable activities; or	Yes <input checked="" type="checkbox"/>
I am making this application pursuant to a	
Statutory function	Yes
A function discharged by virtue of Her Majesty's prerogative	Yes



A. DETAILS of INDIVIDUAL NOTICE GIVERS <i>(fill in as applicable)</i>									
Name									
Delete as appropriate: Mr. Mrs. Miss. Ms. Other title (for example, Rev)									
Surname									
Forenames									
Are you over 18	Yes	No	Date of Birth						
			DD/MM/YYYY						
Place of Birth									
Nationality									
CURRENT POSTAL ADDRESS if different from premises address									
Post Town					Post Code				
Contact Phone number in working hours									
E-mail Address if any <i>(optional)</i>									
Where applicable (if demonstrating a right to work via the Home Office online right to work checking service), the 9-digit "share code" provided to the applicant by the service (please see note 2 for information).									
Share Code									

DETAILS of SECOND INDIVIDUAL NOTICE GIVER <i>(If Applicable)</i>									
Name									
Delete as appropriate: Mr. Mrs. Miss. Ms. Other title (for example, Rev)									
Surname									
Forenames									
Are you over 18	Yes	No	Date of Birth						
			DD/MM/YYYY						
Place of Birth									
Nationality									
CURRENT POSTAL ADDRESS if different from premises address									
Post Town					Post Code				
Contact Phone number in working hours									
E-mail Address if any <i>(optional)</i>									
Where applicable (if demonstrating a right to work via the Home Office online right to work checking service), the 9-digit "share code" provided to the applicant by the service (please see note 2 for information).									
Share Code									

<b>B. OTHER APPLICANTS (fill in as applicable)</b>			
Please provide name and registered address of applicant in full. Where appropriate please give any registered number. In case of partnership or joint venture (other than a body corporate), please give the name and address of each party concerned.			
Name			
NPTC Group of Colleges			
Address			
Caffi Y Gaer NPTC Group of Colleges Glamorgan Street			
Post Town	Brecon	Post Code	LD37DW
Registered number (where applicable)			
N/A			
Description of applicant (for example, partnership, company, unincorporated association etc.)			
NPTC Group of Colleges. Further Education			
Telephone number (if any)			
E-mail address (optional)			

<b>Part 3 Operating Schedule</b>	<b>Day</b>	<b>Month</b>	<b>Year</b>
When do you want the premises licence to start?	0 1	0 3	2 0 2 3
If you wish the licence to be valid only for a limited period, when do you want it to end?			
If 5,000 or more people are expected to attend the premises at any one time please state the number expected to attend.	N/A		
Please give a general description of premises (Please read guidance note 1)			

Café located in the library building. Serving hot and cold drinks and meals for both the public and members and visitors of the college. Providing hospitality for College, library, and local community functions. Area to have licensable activities are outlined in yellow on attached floor plans. Please note outside area is up to the fence only.

What licensable activities do you intend to carry on from the premises? (Please see sections 1 and 14 of the Licensing Act 2003 and Schedule 1 and 2 to the Licensing Act 2003)		
Provision of regulated entertainment (please read guidance note 2)	Please tick <input checked="" type="checkbox"/>	
a) plays (if ticking yes, fill in box A)	YES	NO
b) films (if ticking yes, fill in box B)	YES <input checked="" type="checkbox"/>	NO
c) indoor sporting events (if ticking yes, fill in box C)	YES	NO
d) boxing or wrestling entertainment (if ticking yes, fill in box D)	YES	NO
e) live music (if ticking yes, fill in box E)	YES	NO
f) recorded music (if ticking yes, fill in box F)	YES	NO
g) performances of dance (if ticking yes, fill in box G)	YES	NO
h) anything of a similar description to that falling within (e), (f) or (g) (if ticking yes, fill in box H)	YES	NO
	Please tick <input checked="" type="checkbox"/>	
Provision of late night refreshment (if ticking yes, fill in box I)	YES	NO
Sale / Supply of alcohol (if ticking yes, fill in box J)	YES <input checked="" type="checkbox"/>	NO

**IN ALL CASES PLEASE COMPLETE BOXES K, L, AND M BELOW**

[BOX A] PLAYS Standard days and timings (please read guidance note 7)			Will the performance of a play take place indoors or outdoors or both - Please Tick or insert "YES" in the relevant box. (please read guidance note 3)	Indoors	
Day	Start	Finish		Outdoors	
Mon			Please give further details here (please read guidance note 4)	Both	

Tue			
Wed			<u>State any seasonal variations for performing plays (please read guidance note 5)</u>
Thur			
Fri			<u>Non-standard timings. Where you intend to use the premises for the performance of plays at different times to those listed in the column on the left, please list. (please read guidance note 6)</u>
Sat			
Sun			

<b>[BOX B] FILMS</b> Standard days and timings (please read guidance note 7)			Will the exhibition of films take place indoors or outdoors or both – Please Tick or insert "YES" in the relevant box. (please read guidance note 3)	Indoors	
Day	Start	Finish		Outdoors	
Mon	0900	2300		Both	√
Tue	0900	2300	<u>Please give further details here (please read guidance note 4)</u> Within the College and library spaces		
Wed	0900	2300	<u>State any seasonal variations for the exhibition of films (please read guidance note 5)</u>		
Thur	0900	2300	None		
Fri	0900	2300	<u>Non-standard timings. Where you intend to use the premises for the exhibition of films at different times to those listed in the column on the left, please list. (please read guidance note 6)</u>		
Sat	0900	2300			
Sun	0900	2300	No		

<b>[BOX C]</b> INDOOR SPORTING EVENTS Standard days and timings (please read guidance note 7)			<u>Please give further details here (please read guidance note 4)</u>		
Day	Start	Finish			
Mon					

Tue			<u>State any seasonal variations for indoor sporting events (please read guidance note 5)</u>
Wed			
Thu			
Fri			<u>Non-standard timings. Where you intend to use the premises for indoor sporting events at different times to those listed in the column on the left, please list. (please read guidance note 6)</u>
Sat			
Sun			

[BOX D] BOXING OR WRESTLING ENTERTAINMENT Standard days and timings (please read guidance note 7)			Will the boxing or wrestling entertainment take place indoors or outdoors or both – Please Tick or insert “YES” in the relevant box (please read guidance note 3)	Indoors	
Day	Start	Finish		Outdoors	
Mon			Please give further details here (please read guidance note 4)	Both	
Tue					
Wed					
Thur			<u>State any seasonal variations for boxing or wrestling entertainment (please read guidance note 5)</u>		
Fri					
Sat					
Sun					
			<u>Non-standard timings. Where you intend to use the premises for boxing or wrestling entertainment at different times to those listed in the column on the left, please list. (please read guidance note 6)</u>		

[BOX E] LIVE MUSIC Standard days and timings (please read guidance note 7)			Will the performance of live music take place indoors or outdoors or both – Please Tick or insert “YES” in the relevant box (please read guidance note 3)	Indoors	
Day	Start	Finish		Outdoors	
Mon			Please give further details here (please read guidance note 4)	Both	
Tue					

Wed			<u>State any seasonal variations for the performance of live music (please read guidance note 5)</u>
Thur			
Fri			
Sat			
Sun			

[BOX F] RECORDED MUSIC Standard days and timings (please read guidance note 7)			Will the playing of recorded music take place indoors or outdoors or both - Please Tick or insert "YES" in the relevant box (please read guidance note 3)	Indoors		
Day	Start	Finish		Outdoors		
Mon			Please give further details here (please read guidance note 4)	Both		
Tue						
Wed			<u>State any seasonal variations for playing recorded music (please read guidance note 5)</u>			
Thur						
Fri				<u>Non-standard timings. Where you intend to use the premises for the playing of recorded music at different times to those listed in the column on the left, please list. (please read guidance note 6)</u>		
Sat						
Sun						

[BOX G] PERFORMANCE OF DANCE Standard days and timings (please read guidance note 7)			Will the performance of dance take place indoors or outdoors or both - Please Tick or insert "YES" in the relevant box (please read guidance note 3)	Indoors	
Day	Start	Finish		Outdoors	
Mon			Please give further details here (please read guidance note 4)	Both	
Tue					
Wed			<u>State any seasonal variations for the performance of dance (please</u>		

			<u>read guidance note 5)</u>
Thur			
Fri			<u>Non-standard timings. Where you intend to use the premises for the performance of dance at different times to those listed in the column on the left, please list. (please read guidance note 6)</u>
Sat			
Sun			

<b>[BOX H] ANYTHING OF A SIMILAR DESCRIPTION TO THAT FALLING WITHIN (E), (F) or (G). Standard days and timings (please read guidance note 7)</b>			<u>Please give a description of the type of entertainment you will be providing</u>		
<b>Day</b>	<b>Start</b>	<b>Finish</b>	<b>Will the entertainment be taking place indoors or outdoors or both – Please Tick or insert “YES” in the relevant box (please read guidance note 3)</b>	<b>Indoors</b>	
<b>Mon</b>				<b>Outdoors</b>	
				<b>Both</b>	
<b>Tue</b>			<u>Please give further details here (please read guidance note 4)</u>		
<b>Wed</b>					
<b>Thu</b>			<u>State any seasonal variations for entertainment of a similar description to that falling within (e), (f) or (g) (please read guidance note 5)</u>		
<b>Fri</b>			None		
<b>Sat</b>			<u>Non-standard timings. Where you intend to use the premises for the entertainment of a similar description to that falling within (e), (f) or (g) at different times to those listed in the column on the left, please list. (please read guidance note 6)</u>		
<b>Sun</b>			None		

<b>[BOX I] LATE NIGHT REFRESHMENT Standard days and timings (please read guidance note 7)</b>			<b>Will the provision of late night refreshment take place indoors or outdoors or both – Please Tick or insert “YES” in the relevant box (please read guidance note 3)</b>	<b>Indoors</b>	
<b>Day</b>	<b>Start</b>	<b>Finish</b>		<b>Outdoors</b>	
<b>Mon</b>				<b>Both</b>	
			<u>Please give further details here (please read guidance note 4)</u>		

Tue			
Wed			<u>State any seasonal variations for the provision of late night refreshment (please read guidance note 5)</u>
Thur			
Fri			
Sat			<u>Non-standard timings. Where you intend to use the premises for the provision of late night refreshment at different times to those listed in the column on the left, please list. (please read guidance note 6)</u>
Sun			

<b>[BOX J]</b> SUPPLY OF ALCOHOL Standard days and timings (please read guidance note 7)			Will the sale of alcohol be for consumption on or off the premises or both – Please Tick or insert "YES" in the relevant box (please read guidance note 8)	On	
Day				Off	
Start	Finish			Both	√
Mon	0900	2300	<u>State any seasonal variations for the supply of alcohol (please read guidance note 5)</u>	None	
Tue	0900	2300			
Wed	0900	2300			
Thur	0900	2300	<u>Non-standard timings. Where you intend to use the premises for the supply of alcohol at different times to those listed in the column on the left, please list. (please read guidance note 6)</u>	None	
Fri	0900	2300			
Sat	0900	2300			
Sun	0900	2300			

**State the Name and Details of the Individual whom you wish to specify on your licence as the – (DPS) Designated Premises Supervisor. (Please see declaration about the entitlement to work in the checklist at the end of the form):  
(A DPS is required to be a Personal Licence Holder)**

Delete as appropriate: Mr.

Surname	
Forenames	



Are you over 18	Date of Birth DD/MM/YYYY
Place of Birth	
CURRENT ADDRESS of Designated Premises Supervisor if different from premises address	

Post Town	Post Code
Personal Licence Number of DPS (if any)	
Issuing Licensing Authority, if applicable	

**[BOX K] Please highlight any adult entertainment or services, activities, other entertainment or matters ancillary to the use of the premises that may give rise to concern in respect of children (Please Read Guidance Note 9)**

<b>[BOX L] HOURS PREMISES ARE OPEN TO THE PUBLIC Standard days and timings (please read guidance note 7)</b>			<b>State any seasonal variation (please read guidance note 5)</b>
<b>Day</b>	<b>Start</b>	<b>Finish</b>	<u>Non-standard timings. Where you intend to use the premises to be open to the public at different times to those listed in the column on the left, please list. (please read guidance note 6)</u>
Mon	0900	2330	
Tue	0900	2330	
Wed	0900	2330	
Thu	0900	2330	
Fri	0900	2330	
Sat	0900	2330	
Sun	0900	2330	

**[BOX M] Please describe the steps you intend to take to promote the four licensing objectives:**

**a) General – all four licensing objectives (b,c,d,e) (please read guidance note 10)**

**b) The prevention of crime and disorder**

c) Public safety
d) The prevention of public nuisance
e) The protection of children from harm

CHECKLIST: Please Tick or insert "YES" in the boxes below to indicate agreement	
• I have made or enclosed payment of the fee	✓
• I have enclosed a plan of the premises	✓
• I have sent copies of this application to responsible authorities and others where applicable	LA TO SEND
• I have enclosed the consent form completed by the individual I wish to be the Designated Premises Supervisor, if applicable	✓
• I understand that I must now advertise my application	✓
• I understand that if I do not comply with the above requirements my application will be rejected	✓
• [Applicable to all individual applicants, including those in a partnership which is not a limited liability partnership, but not companies or limited liability partnerships] I have included documents demonstrating my entitlement to work in the United Kingdom or my share code issued by the Home Office online right to work checking service (please read note 15).	N/A

IT IS AN OFFENCE, UNDER SECTION 158 OF THE LICENSING ACT 2003, TO MAKE A FALSE STATEMENT IN OR IN CONNECTION WITH THIS APPLICATION. THOSE WHO MAKE A FALSE STATEMENT MAY BE LIABLE ON SUMMARY CONVICTION TO A FINE OF ANY AMOUNT.

IT IS AN OFFENCE UNDER SECTION 24B OF THE IMMIGRATION ACT 1971 FOR A PERSON TO WORK WHEN THEY KNOW, OR HAVE REASONABLE CAUSE TO BELIEVE, THAT THEY ARE DISQUALIFIED FROM DOING SO BY REASON OF THEIR IMMIGRATION STATUS. THOSE WHO EMPLOY AN ADULT WITHOUT LEAVE OR WHO IS SUBJECT TO CONDITIONS AS TO EMPLOYMENT WILL BE LIABLE TO A CIVIL PENALTY UNDER SECTION 15 OF THE IMMIGRATION, ASYLUM AND NATIONALITY ACT 2006 AND PURSUANT TO SECTION 21 OF THE SAME ACT, WILL BE COMMITTING AN OFFENCE WHERE THEY DO SO IN THE KNOWLEDGE, OR WITH REASONABLE CAUSE TO BELIEVE, THAT THE EMPLOYEE IS DISQUALIFIED.

Part 4 – Signatures (please read guidance note 11)	
Signature of applicant or applicant's solicitor or other duly authorised agent. (See guidance note 12) If signing on behalf of the applicant please state in what capacity.	
Declaration	<ul style="list-style-type: none"> <li>• [Applicable to individual applicants only, including those in a partnership which is not a limited liability partnership] I understand I am not entitled to be issued with a licence if I do not have the entitlement to live and work in the UK (or if I am subject to a condition preventing me from doing work relating to the carrying on of a licensable activity) and that my licence will become invalid if I cease to be entitled to live and work in the UK (please read guidance note 15).</li> <li>• The DPS named in this application form is entitled to work in the UK (and is not subject to conditions preventing him or her from doing work relating to a licensable activity) and I have seen a copy of his or her proof of entitlement to work, if appropriate (please see note 15).</li> </ul>
Signature	
Date	8/2/23
Capacity	
For joint applications signature of 2nd applicant or 2nd applicant's solicitor or other authorised agent. (please read guidance note 13) If signing on behalf of the applicant please state in what capacity.	
Signature	
Date	
Capacity	

Contact name (where not previously given) and postal address for correspondence associated with this application (please read guidance note 14)			
NPTC GROUP OF COLLEGES NEATH COLLEGE DWR Y FELIN ROAD NEATH			
Post Town	NEATH PORT TALBOT	Postcode	SA107RF
Telephone number			
E-mail address (optional)			

This page is intentionally left blank

# ANNEX B1

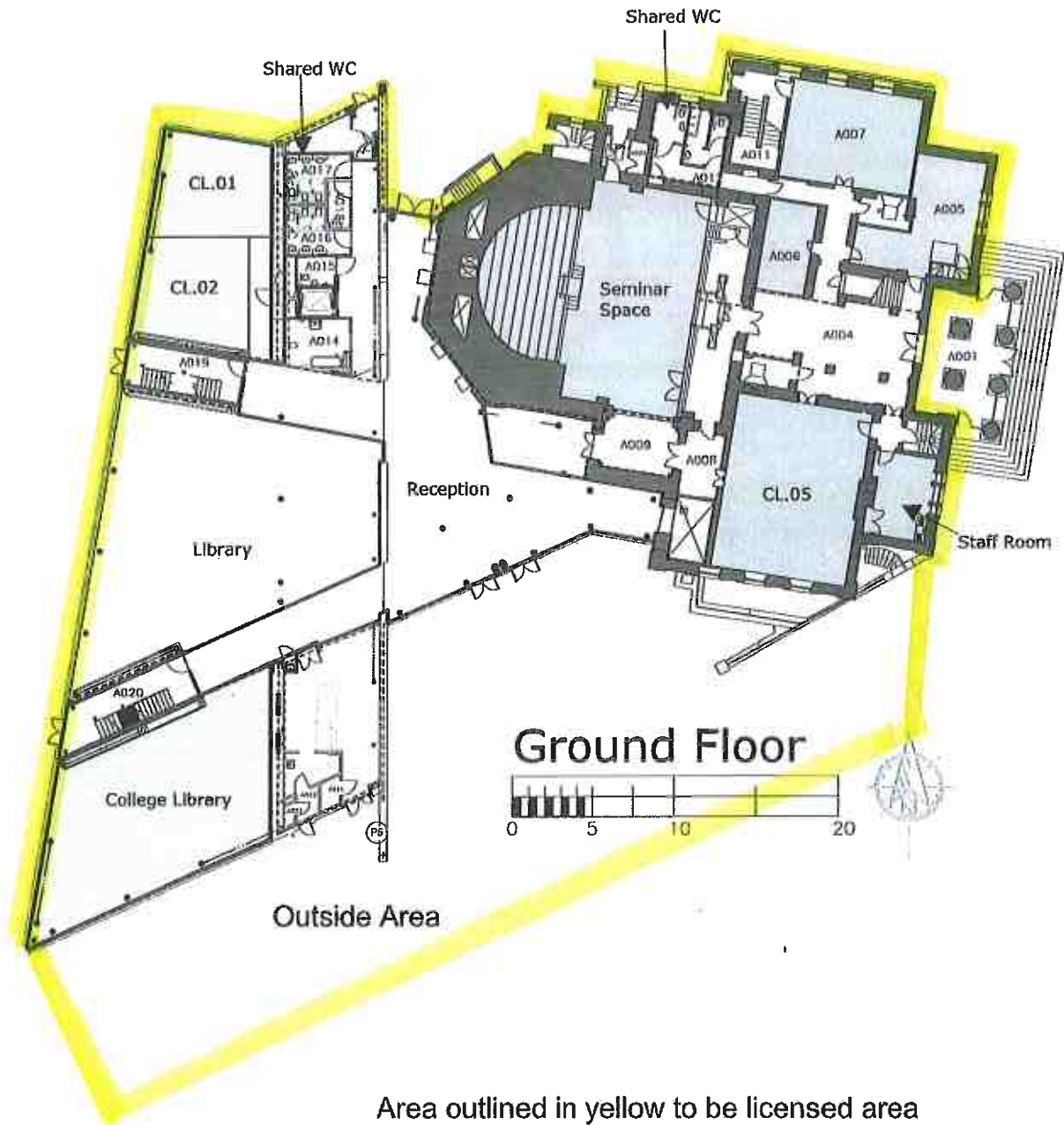

Area outlined in yellow to be licensed area

REVISED	
No.	Description

Author	Checked	Scale



## **ANNEX C**

### **Objector No 1**

Public safety will be put at risk by the increased consumption of alcohol in such a public place as Y Gaer and the potential for public disorder will rise as a result of excess alcohol consumption . National statistics prove the link between alcohol consumption and the risk of disorder.

As a large number of young citizens will be receiving education and training at Y Gaer there will be increased opportunity for a variety of public nuisance offences to take place and young people, as well as other members of the public, could be at risk of harm.

If you would like me to visit your office for a face to face discussion on this topic please let me know. I have also been in contact with Cllr. Dorrance regarding this matter.

I hope that members of the public are free to express their genuine concerns over such an important matter and that you are now able to accept my reasons for objecting to this application.

### **Objector No2**

With reference to the application for an alcohol license at the Gaer Library Brecon, I wish to submit an objection as follows:

>

> The Prevention of Public Nuisance;

the library is that a library- mixing alcohol in the equation does not encourage quiet , pensive time. I would go so far as to say that where many people especially students would require quiet study time it is not necessary to add alcohol which will inevitably cause a public nuisance on occasion

> The Protection of Children from harm

I would never agree that students need to be encouraged to partake in alcohol during their learning day. The age of admission to the college is 16 and most pursue a two year course. The majority are therefore underage to consume alcohol and do not need the temptation to mix alcohol within their learning environment If the argument is to encourage tourists to lunch there I believe it is not necessary or a suitable place- there are adequate other venues in town. Most tourists would be looking for food and if looking for alcohol would go into a dedicated pub before a library.

### **Objector No 3**

With regard to your advice, I would be grateful if you would align my objections to each and all of the four categories listed.

- The Prevention of Crime & Disorder
- Public Safety
- The Prevention of Public Nuisance; and
- The Protection of Children from harm
- I would like to place on record an objection to this application, seen in the Brecon and Radnor Express (Dated 15.2.2023)

- Reasons:
- Not necessary
- Hours listed are far too wide
- Believe it is not wanted by Building users, particularly Library and Museum users like myself.
- Do not believe it is necessary for the small NPTC college part of the building.
- Catering training , etc. can be carried on without real alcohol.
- There is a very limited catering facility at y Gaer, not warranting a licence.
- If needed for functions, etc. an application could be made on an individual basis for specific times and dates.
- Students and workers should not be drinking during a working day.
- Toilet facilities very limited at y Gaer
- Staffing very limited at y Gaer
- Facilities limited at y Gaer
- Indoors and Out?
- - would not support any drinking in the outside areas of y Gaer. - (Rubbish, Noise, Behaviour issues, etc.)
- Consider a public consultation with full details of proposal should take place before such an application

#### **Objector No4**

I consider that the sale of alcohol from the café as detailed below would risk aggravating public nuisance from aggressive behaviour and littering in the gaer gardens and adjacent carpark. There is already a problem in the area of which the police are aware.

#### **Objector No5**

I should like to object to the proposed licence for the cafe at Y Gaer to be open from 9.00am until 23.00pm to sell alcohol and show films on the following grounds -

1. The selling of alcohol in a space adjacent to where small children are potentially reading and being read to. The said young children are likely to be in the Library at any time of the day that it is open, therefore exposed to alcohol.
2. The possibility of public nuisance being caused by young students from NYPT College drinking during the day and becoming rowdy in the Library where there are not only young children but also the elderly and infirm who constitute most of the Library's clients.
3. The possibility of disorder among said students if alcohol is available all day, every day.